

NOTES:

1.0 ELECTRICAL SPECIFICATIONS:

- 1.1 FREQUENCY RANGE: DC to 18.0 GHz
- 1.2 MAXIMUM INPUT POWER: 0.5 WATTS @ +25°C  
DERATED LINEARLY TO 0 WATTS @ +125°C
- 1.3 OPERATING TEMP. RANGE: -65°C TO +125°C
- 1.4 IMPEDANCE: 50 OHMS
- 1.5 VSWR: 1.10 +0.01F(GHz)

2.0 MARKING: NONE REQUIRED

3.0 DIMENSIONS IN PARENTHESIS ARE IN MILLIMETERS.

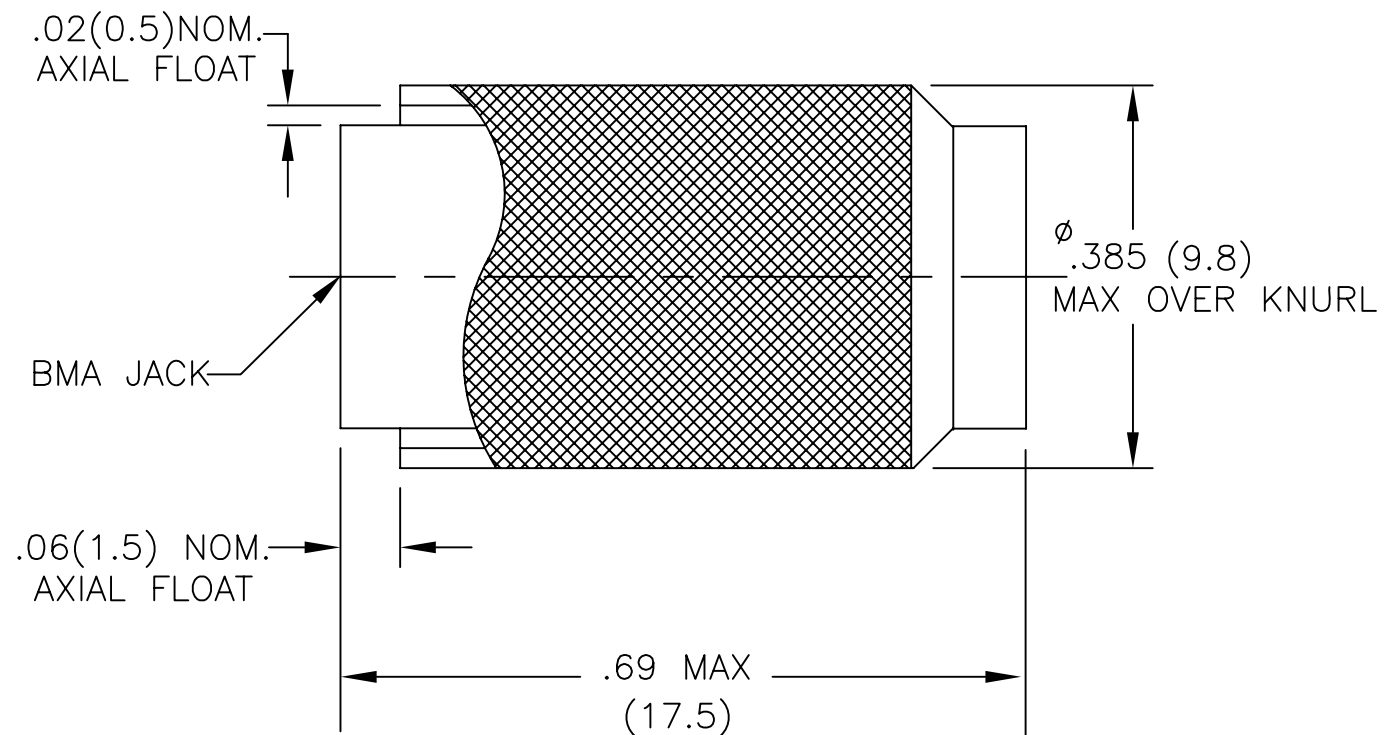

REV.	DESCRIPTION	DATE
-	RELEASED	2/10/99
-1	ADDED TITLEBLOCK	11/14/05

UNLESS OTHERWISE NOTED DIMENSIONS ARE IN INCHES AND TOLERANCES ARE:  3 PLACE DECIMALS ±.005 2 PLACE DECIMALS ±.02 FRACTIONS ±1/64 PARALLELITY: T.I.R. _____ FLATNESS: T.I.R. _____ CONCENTRICITY: T.I.R. _____ ANGLES AND PERPENDICULARITY: ±1°	FSCM NO. <b>34078</b>	<b>MIDWEST MICROWAVE</b>	
	NOTICE: The information contained in this drawing is proprietary and must not be used without the permission of Midwest Microwave	TITLE TERMINATION	
DRAWN/DATE D.GORDON 2/10/99	ENG./DATE G.KOZAK 2/10/99	DRAWING NUMBER TRM-2191-FO-BMA-02	
CHECKED/DATE	APPROVED/DATE	SCALE: 5=1	SHEET 1 of 1