

LOC	QTY	ZONE	LTN	DESCRIPTION	DATE	APPD
G	14		H	REVISED PER 0720-0230-93	2/25/94	AMP

REVISIONS	
NO	DESCRIPTION
1	REVISED PER 0720-0230-93

METPRIO
DIMENSIONS LISTED IN MM [INCHES]

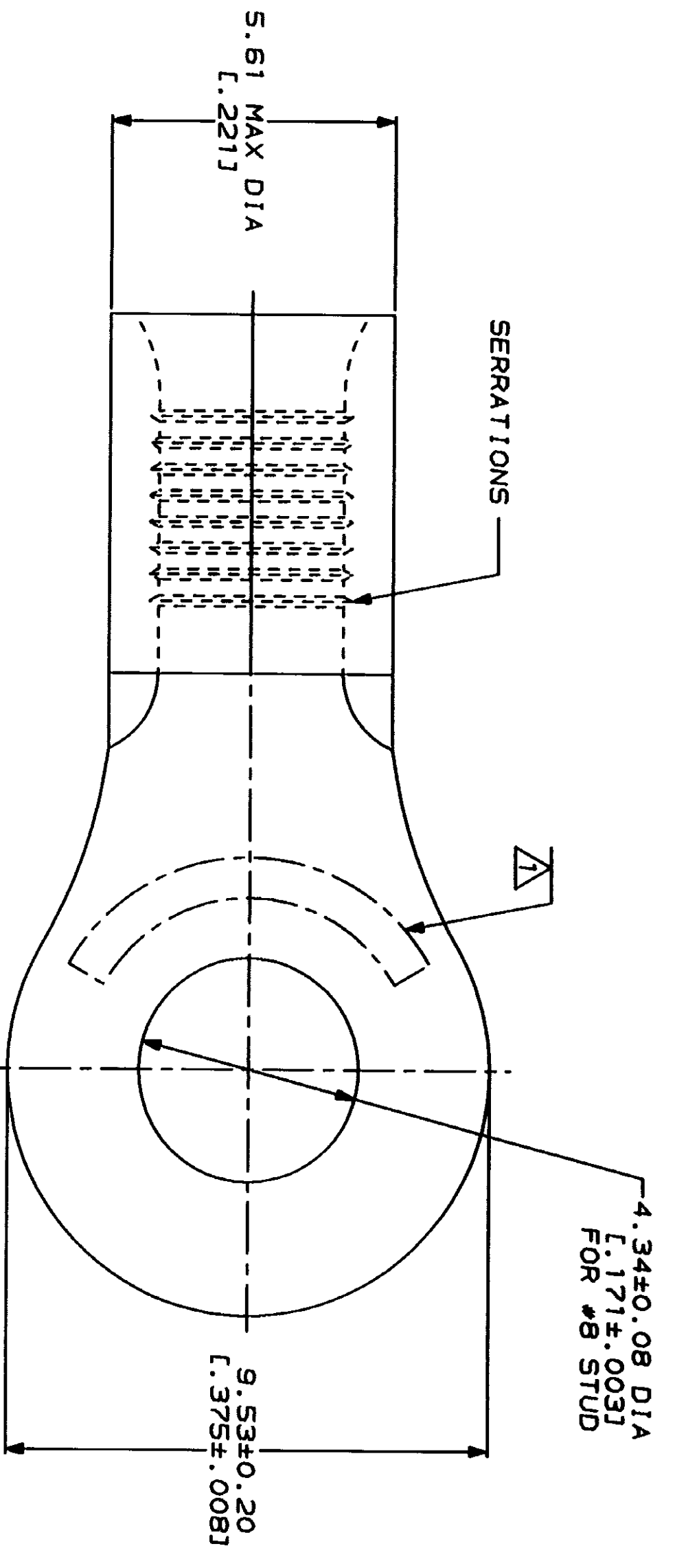

AMP WIRE RANGE	UL E13288 Listed
12-10 AWG STRANDED	12-10 AWG STRANDED
LR7189 Certified	MILITARY P/N AND CLASS
NOT CERTIFIED	NOT APPLICABLE

△ STAMP AMP 12-10* APPROX AS SHOWN

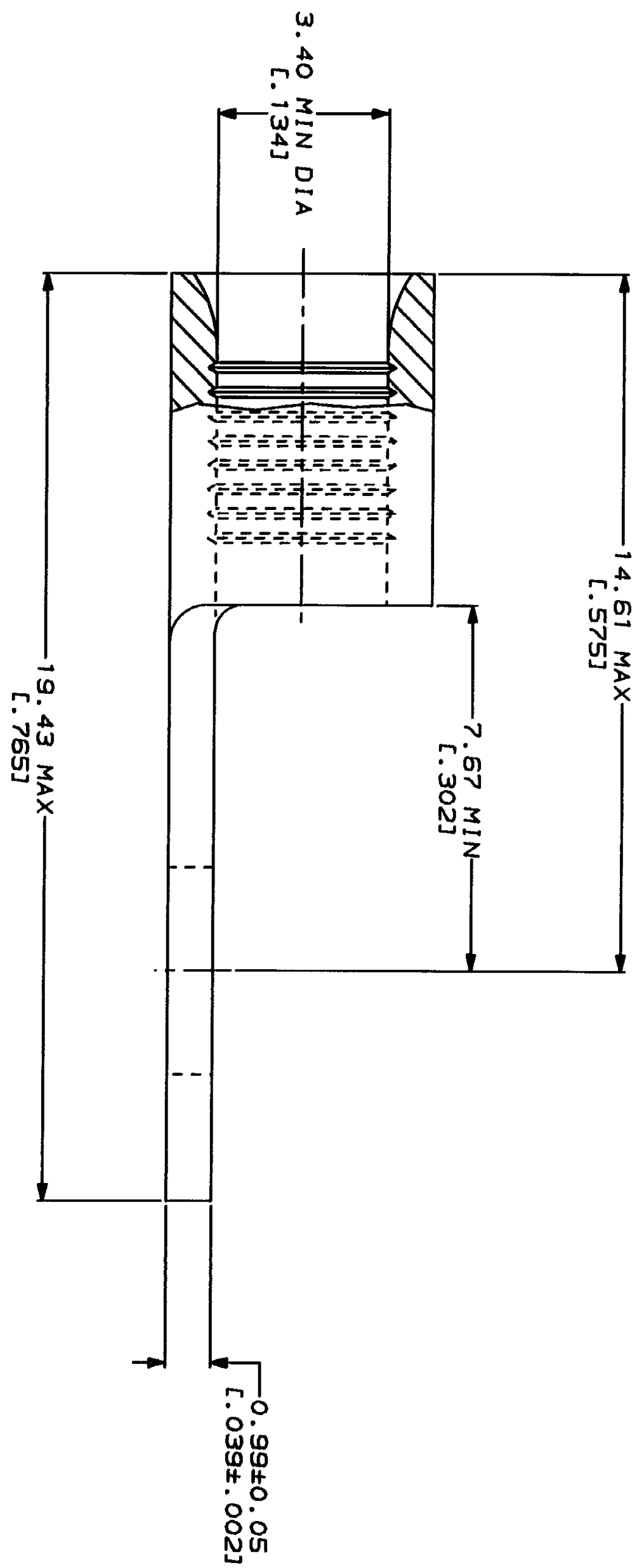

AMP INCORPORATED
CUSTOMER SERVICE SYSTEMS

FOR ADDITIONAL
PRODUCT INFORMATION OR
COPIES OF DRAWINGS
AND TECHNICAL DOCUMENTS
1-800-522-6752

FOR APPLICATION
TOOLING INFORMATION
1-800-722-1111

FOR ORDER ENTRY
TOOLING ASSISTANCE CENTER
1-800-526-5142

MAX RECOMMENDED OPERATING
TEMPERATURE:
170°C MAX

VOLTAGE RATING:
NOT APPLICABLE

WIRE CROSS SECTIONAL AREA RANGE:
2.62-6.64mm² [5,180-13,100] CIR MILS
STRANDED

THIS DRAWING IS A CONTROLLED DOCUMENT FOR AMP INCORPORATED. IT IS SUBJECT TO CHANGE WITHOUT NOTICE. ANY REVISIONS SHOULD BE COMPLETED FOR THE LATEST REVISION.

DO NOT SCALE PRINT.
UNLESS SPECIFIED
DIMENSIONS IN—LENGTH—
TOLERANCES ON—
2 P/L DEC ±
3 P/L DEC ±
ANGLES
PATTERN

COPPER PER
ASTM B-152
ANNEALED

FINISH
TIN PLATE
0.00254L [0.00100] MIN
THK PER MIL-T-10727

DR 2-9-93
IA BRINKMAN

CHK 2-9-93
DA PATTERSON

APPD 2-9-93
DE MILLER

APPD 2-9-93
JL NECKLEY

PRODUCT SPEC

APPLICATION SPEC

WEIGHT



AMP Incorporated
Harrisburg, PA 17105-3608

TERMINAL, RING TONGUE,
BUDGET

SIZE
CAGE CODE
00779
DRAWING NO
31113

31113
PART NO

31113

CUSTOMER DRAWING