

1 0 1 0 2  
3 0 0 4  
a-L-b (+)

SPST  
CONTACT CONFIGURATION

PARTS LIST			
ITEM	QTY.	PART NO.	PART DESCRIPTION
1	1	F040008	D16 OA S1 1
2	1	F050421	50-004-21 (YEL Led)
3	1	F050303	50-003-03 (Transparent ORG lens)

NOTES:

1. ALL DIMENSIONS IN MM
2. GENERAL TOLERANCE: X.X=±0.4  
X.XX=±0.25
3. RATINGS: 5A @250V AC  
8A @125V AC
4. TRAVEL: 3.0mm
5. CONTACT MATERIAL:  
COPPER ALLOY W/Silver Plating
6. LAMP VOLTAGE: 12V

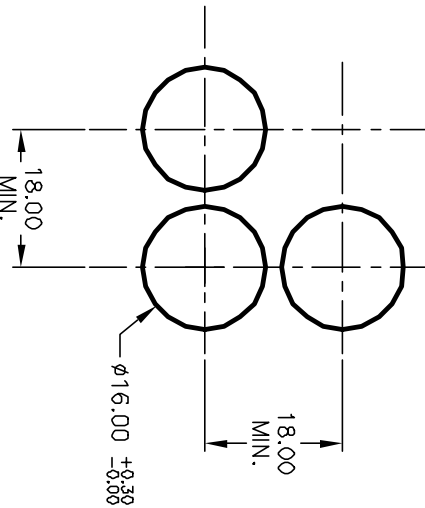

**E-SWITCH®**

TITLE  
D16 OA S11 J YEL DRG  
TRANSPARENT/CONCAVE LENS

REV.	ECN No.	DESCRIPTION	DATE	CHKD
A	12563	RELEASED FOR PRODUCTION	11/14/02	CJB

SCALE	DATE	DR	DWG	REV
1.5:1	11/14/02	CB	XF0526P	A

THE INFORMATION CONTAINED IN THIS DOCUMENT IS PROPRIETARY TO E-SWITCH AND IS NOT TO BE COPIED OR TRANSFERRED