

| MATERIAL NUMBER | ENGINEERING NUMBER | MOUNTING OPTION | CKT SIZE | DIM A | DIM B | DIM C | DIM D |
|-----------------|--------------------|-----------------|----------|---------|---------|---------|---------|
| 46999-0096 | 5559-04P2-225 | W/EARS | 4 | .709 | .496 | .724 | .921 |
| 26-01-3093 | 5559-04P3-225 | NO EARS | | (18.00) | (12.60) | (18.40) | (23.40) |
| NOT TOOLED | 5559-05P2-225 | W/EARS | 5 | .874 | .661 | .890 | 1.087 |
| 50-36-1681 | 5559-05P3-225 | NO EARS | | (22.20) | (16.80) | (22.60) | (27.60) |

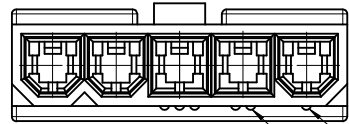
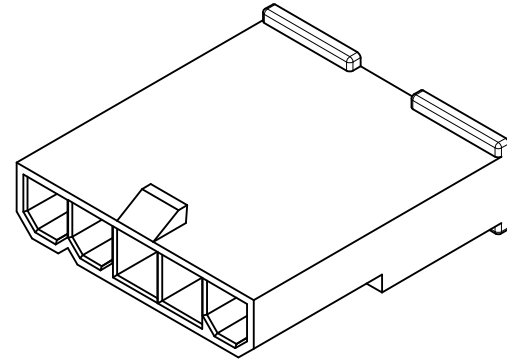
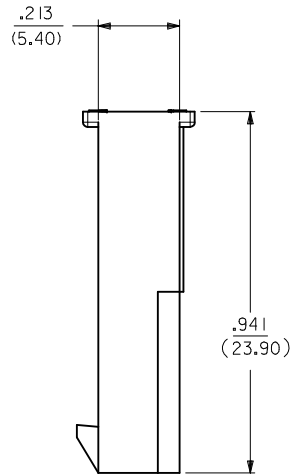
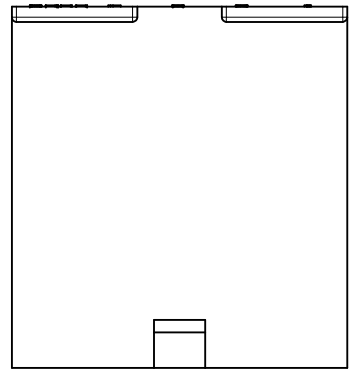
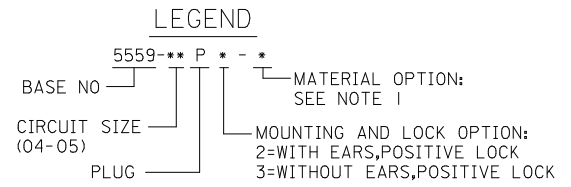
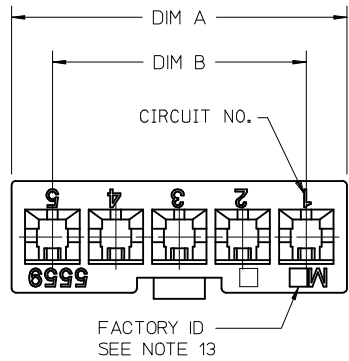

5 CKT WITHOUT MOUNTING EARS SHOWN

RIB INDICATES CIRCUIT #1

RIBS INDICATE CIRCUIT #2

- NOTES:**
- 1) MATERIAL:
"225" = NYLON (PA6), UL94V-0, COLOR: BLACK; IEC 60335-1, 4th EDITION GLOW WIRE CAPABLE.
 - 2) FINISH: NOT APPLICABLE
 - 3) PRODUCT SPECIFICATION: PS-5556-001
 - 4) PACKAGING: BULK PER PK-5559-003
 - 5) PART MATES WITH MOLEX RECEPTACLE #5557.
 - 6) PART TO BE USED WITH MOLEX MALE TERMINAL #5558.
 - 7) PART IS NOT DESIGNED FOR CURRENT SHARING.
 - 8) CONNECTORS ARE NOT TO BE MATED OR UNMATED WHILE CIRCUITS ARE LIVE.
 - 9) WIRES ARE TO BE DRESSED IN SUCH A MANNER TO ALLOW THE TERMINALS TO FLOAT FREELY IN THE POCKET.
 - 10) PANEL MOUNT VERSION IS FOR USE WITH .031-.079/(0.80/2.00) THICK PANELS. PANEL SHOULD BE PUNCHED IN THE DIRECTION OF CONNECTOR INSERTION.
 - 12) PART CONFORMS TO CLASS "B" REQUIREMENTS OF COSMETIC SPECIFICATION PS-45499-002 WITH THE EXCEPTION OF DISCOLORATION, FLASH AND SINK MEET CLASS "C" REQUIREMENTS.
 - 13) FACTORY ID MAY BE LOCATED ON EARS.

| ADD SECTION Z-Z IEC NO: UCP2013-4208 DRW: NGUYEN 2014/01/03 CHKD: J. BELL 2014/01/03 APPR: FSMITH 2014/05/16 | QUALITY SYMBOLS | GENERAL TOLERANCES (UNLESS SPECIFIED) <table border="1"> <thead> <tr> <th></th> <th>mm</th> <th>INCH</th> </tr> </thead> <tbody> <tr> <td>4 PLACES</td> <td>± .010</td> <td>± .0004</td> </tr> <tr> <td>3 PLACES</td> <td>± .010</td> <td>± .0004</td> </tr> <tr> <td>2 PLACES</td> <td>± 0.25</td> <td>± .010</td> </tr> <tr> <td>1 PLACE</td> <td>± 0.38</td> <td>± .015</td> </tr> <tr> <td>0 PLACE</td> <td>±</td> <td>±</td> </tr> </tbody> </table> | | mm | INCH | 4 PLACES | ± .010 | ± .0004 | 3 PLACES | ± .010 | ± .0004 | 2 PLACES | ± 0.25 | ± .010 | 1 PLACE | ± 0.38 | ± .015 | 0 PLACE | ± | ± | DIMENSION STYLE IN/MM DRAWN BY: LSCHMIDT DATE: 2007/07/02 CHECKED BY: ADERR DATE: 2007/07/03 APPROVED BY: FSMITH DATE: 2011/03/10 | SCALE 4:1 DESIGN UNITS METRIC THIRD ANGLE PROJECTION | TITLE MINI-FIT JR. SERIES PLUG SINGLE ROW (GLOW WIRE) molex | MATERIAL NO. SEE CHART SIZE C | DOCUMENT NO. SD-5559-525 SHEET NO. 1 OF 2 |
|---|---|--|---------|----|------|----------|--------|---------|----------|--------|---------|----------|--------|--------|---------|--------|--------|---------|---|---|---|--|---|--|--|
| | | mm | INCH | | | | | | | | | | | | | | | | | | | | | | |
| | 4 PLACES | ± .010 | ± .0004 | | | | | | | | | | | | | | | | | | | | | | |
| | 3 PLACES | ± .010 | ± .0004 | | | | | | | | | | | | | | | | | | | | | | |
| 2 PLACES | ± 0.25 | ± .010 | | | | | | | | | | | | | | | | | | | | | | | |
| 1 PLACE | ± 0.38 | ± .015 | | | | | | | | | | | | | | | | | | | | | | | |
| 0 PLACE | ± | ± | | | | | | | | | | | | | | | | | | | | | | | |
| DRAFT WHERE APPLICABLE MUST REMAIN WITHIN DIMENSIONS | THIS DRAWING CONTAINS INFORMATION THAT IS PROPRIETARY TO MOLEX INCORPORATED AND SHOULD NOT BE USED WITHOUT WRITTEN PERMISSION | | | | | | | | | | | | | | | | | | | | | | | | |
| A6 | | | | | | | | | | | | | | | | | | | | | | | | | |
| REV: | | | | | | | | | | | | | | | | | | | | | | | | | |

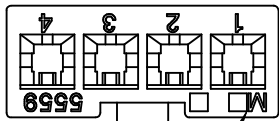

FACTORY ID
SEE NOTE 13

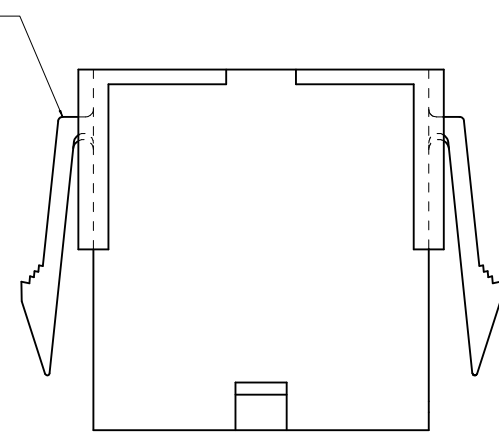
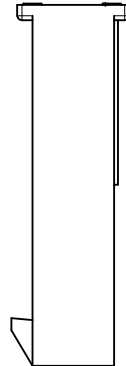
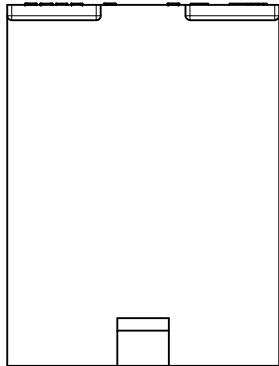

WITH MOUNTING EARS

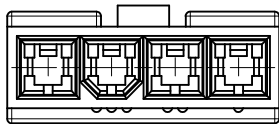

4 CKT WITHOUT
MOUNTING EARS SHOWN

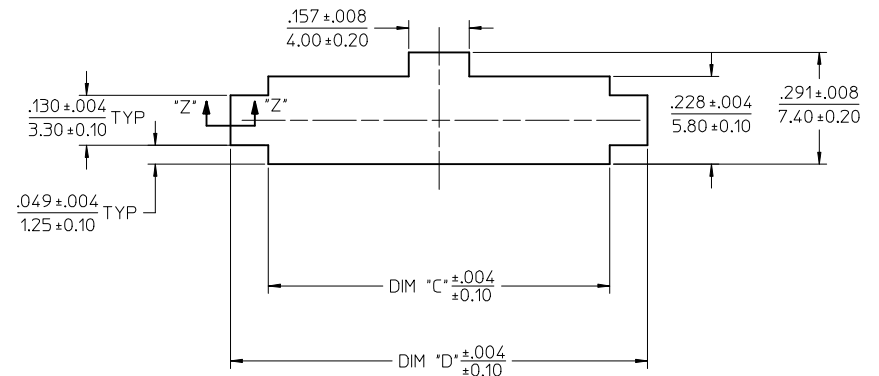
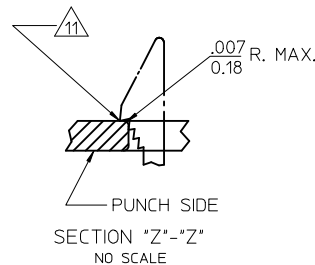

RECOMMENDED PANEL CUT-OUT
(SEE NOTE 10 & 11)

| SEE SHEET 1 EC NO: UCP2013-4208 DRAWN: NGUYEN 2014/01/03 CHKD: BELL 2014/01/03 APPR: FSMITH 2014/05/16 | QUALITY SYMBOLS | GENERAL TOLERANCES (UNLESS SPECIFIED) <table border="1"> <thead> <tr> <th></th> <th>mm</th> <th>INCH</th> </tr> </thead> <tbody> <tr> <td>4 PLACES</td> <td>± .004</td> <td>± .0001</td> </tr> <tr> <td>3 PLACES</td> <td>± .010</td> <td>± .0004</td> </tr> <tr> <td>2 PLACES</td> <td>± .015</td> <td>± .0006</td> </tr> <tr> <td>1 PLACE</td> <td>± .038</td> <td>± .0015</td> </tr> <tr> <td>0 PLACE</td> <td>± .075</td> <td>± .0030</td> </tr> </tbody> </table> | | mm | INCH | 4 PLACES | ± .004 | ± .0001 | 3 PLACES | ± .010 | ± .0004 | 2 PLACES | ± .015 | ± .0006 | 1 PLACE | ± .038 | ± .0015 | 0 PLACE | ± .075 | ± .0030 | DIMENSION STYLE IN/MM | SCALE 1:1 | DESIGN UNITS METRIC | THIRD ANGLE PROJECTION |
|--|-----------------------|---|---|------------------------------------|------------------------------------|----------------------------|--------|---------|----------|--------|---------|----------|--------|---------|---------|--------|---------|---------|--------|---------|---------------------------------|---------------------|-------------------------------|------------------------|
| | | mm | INCH | | | | | | | | | | | | | | | | | | | | | |
| | 4 PLACES | ± .004 | ± .0001 | | | | | | | | | | | | | | | | | | | | | |
| | 3 PLACES | ± .010 | ± .0004 | | | | | | | | | | | | | | | | | | | | | |
| 2 PLACES | ± .015 | ± .0006 | | | | | | | | | | | | | | | | | | | | | | |
| 1 PLACE | ± .038 | ± .0015 | | | | | | | | | | | | | | | | | | | | | | |
| 0 PLACE | ± .075 | ± .0030 | | | | | | | | | | | | | | | | | | | | | | |
| DESCRIPTION A6 | DRAWN BY LSCHEMIDT | DATE 2007/07/02 | TITLE MINI-FIT JR. SERIES PLUG SINGLE ROW (GLOW WIRE) | MATERIAL NO. SEE SHEET 1 | DOCUMENT NO. SD-5559-525 | SHEET NO. 2 OF 2 | | | | | | | | | | | | | | | | | | |
| DRAFT WHERE APPLICABLE MUST REMAIN WITHIN DIMENSIONS | ANGULAR ±1/2° | APPROVED BY FSMITH | DATE 2011/03/10 | molex | | | | | | | | | | | | | | | | | | | | |
| THIS DRAWING CONTAINS INFORMATION THAT IS PROPRIETARY TO MOLEX INCORPORATED AND SHOULD NOT BE USED WITHOUT WRITTEN PERMISSION | | | | | | | | | | | | | | | | | | | | | | | | |