



ACTUAL SIZE

ORDERING CODES

MODEL CMC 321 RTP

CMC 321 (LENS)
RNG 234 (RETAINER)
RNG 268 (RETAINER)

COLOR _____

RTP Red Transparent BTP Blue Transparent
ATP Amber Transparent YTP Yellow Transparent
GTP Green Transparent CTP Clear Transparent

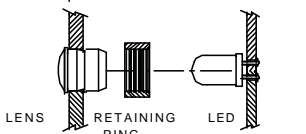
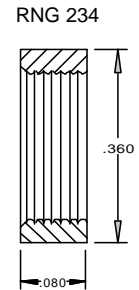
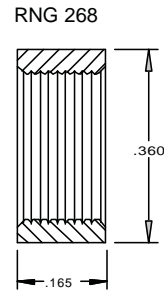
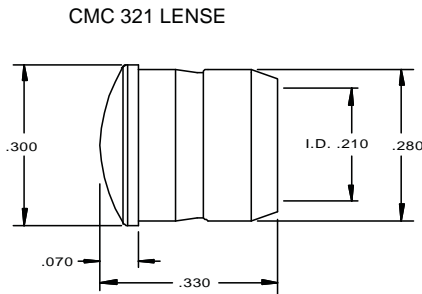
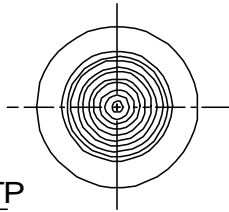

PCB TO PANEL MOUNTING

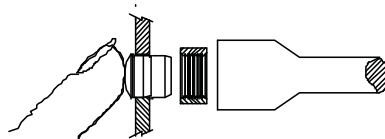

RETAINING RING INSTALLATION

Hold the lens tight to the panel using any suitable device which will not mark the lens surface. Press the ring into place using a 5/16" nut driver.

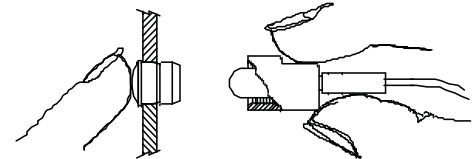

CONNECTOR INSTALLATION

Hold the lens tight to the panel using any suitable device which will not mark the lens surface. Press the connector into place.

NOTES:

MATERIAL: Lens - Polycarbonate
Retaining Ring - Polypropylene
DESIGN: Low profile lens using fresnel rings.
MOUNTING: Mounts thru the front of panel.
Hole size 9/32" (7.2mm) on 3/8" centers.
For PCB mounted LED use RNG 268 Retainer.
Panel thickness with CNX connector:
.030 to .070 use RNG 234 spacer
.105 to .130 None Required

See VCC brochure for information on CNX connectors.

U.S. PAT. PEND.

REVISIONS			
NO	DESCRIPTION	DATE	BY
1			
2			
3			
4			
5			

CLIPLITE® CMC 321 LENSE



VISUAL COMMUNICATIONS COMPANY, INC.
7920-F Arjons Drive San Diego, California 92126 U.S.A.
Phone (858) 549-6900 Fax (858) 549-3520 e-mail vccsales@vcclite.com

TOLERANCES	SCALE	N/A	DATE	11/07/99	DRAWING NO.
DECIMAL ±.010	DIAMETER	.003 TIR	DRAWN BY	JMS	CMC 321A
ANGLE ± 30'	RADII	.008 Max	CHK'D		