

Apr.1.2017 Copyright 2017 HIROSE ELECTRIC CO., LTD. All Rights Reserved.

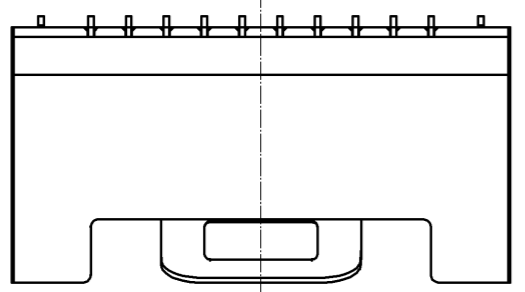

A (10 : 1)

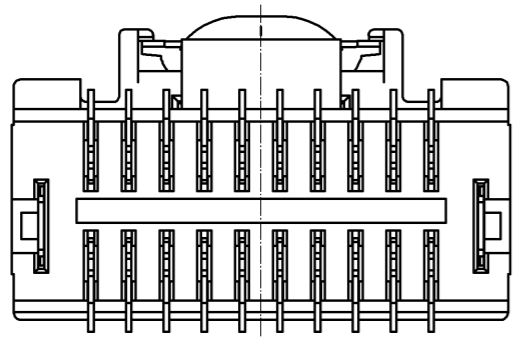
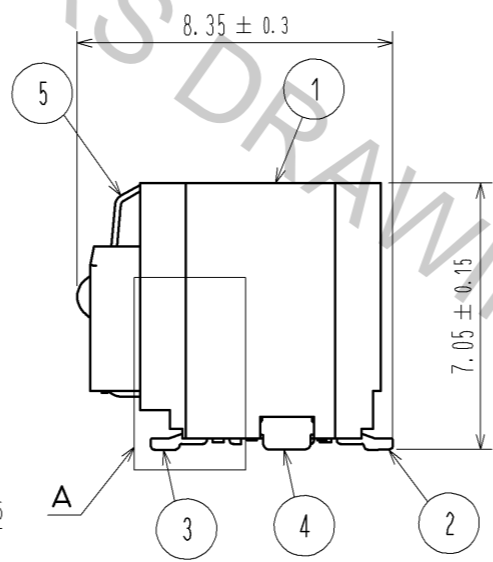
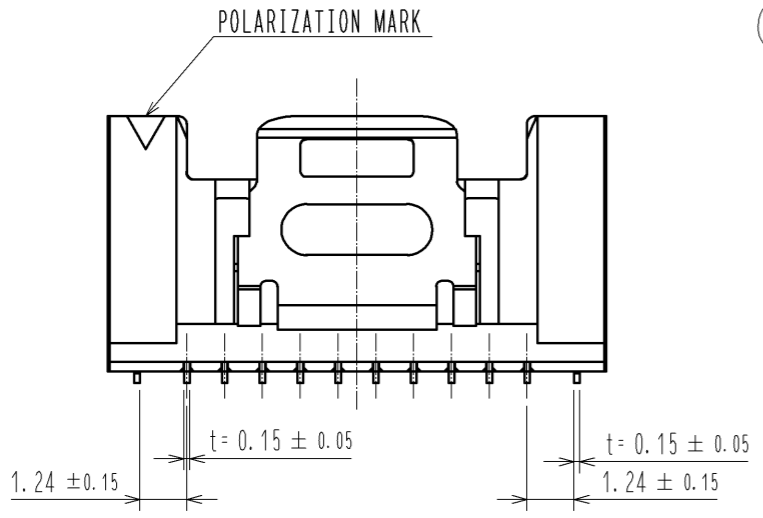
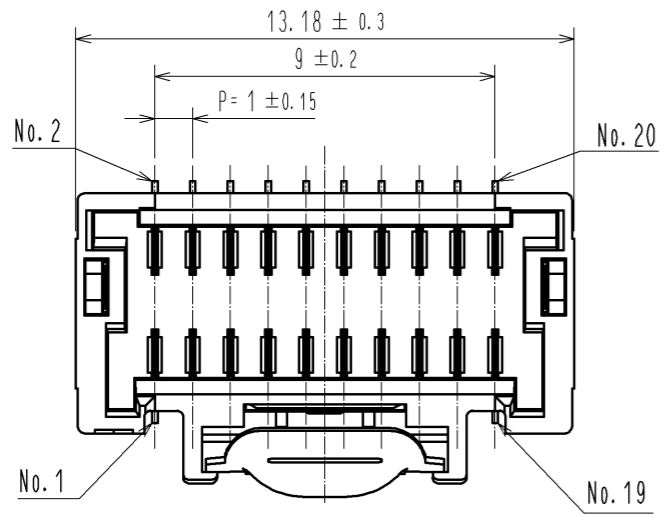
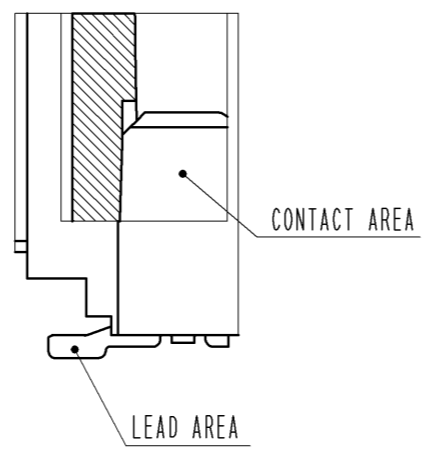

RECOMMENDED PCB LAYOUT
(MOUNTING SURFACE SIDE) (FREE)

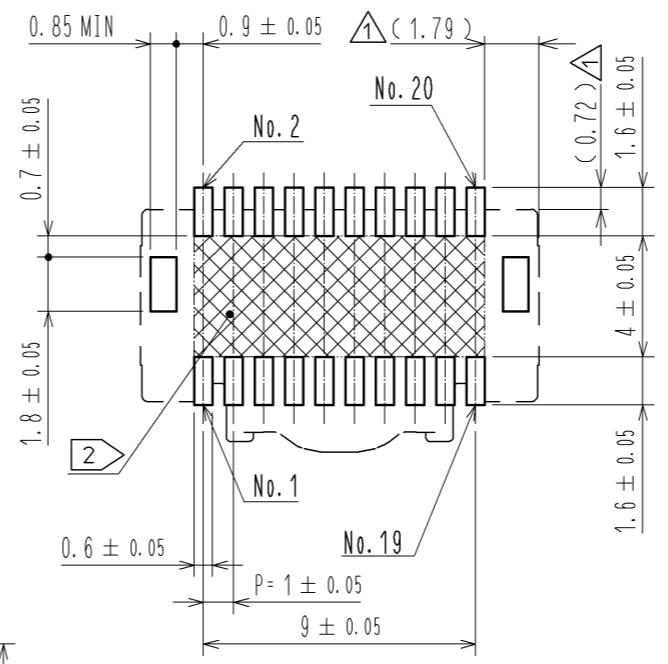

RECOMMENDED METAL MASK(FREE)
THICKNESS : 0.1mm

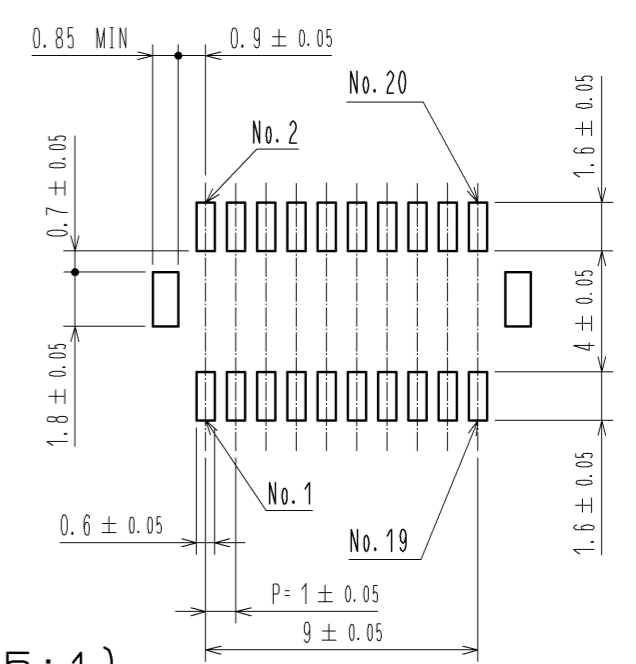

MATING FIGURE (5 : 1)

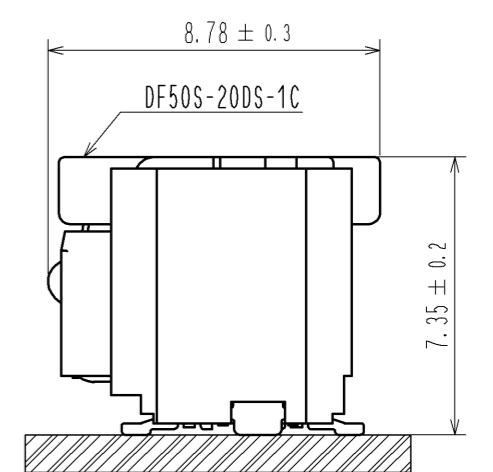
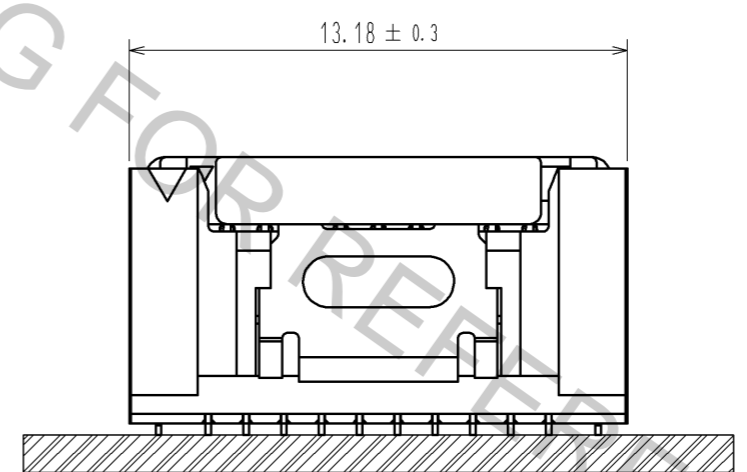

- NOTES 1. LEAD CO-PLANARITY SHALL BE 0.1 mm MAX.
 2. AREA INDICATED MUST BE FREE OF CONDUCTIVE TRACES OR THE CONDUCTIVE TRACES MUST BE COVERED BY RESIST FILM.
 3. PLEASE CONSULT HIROSE WHEN THE PRODUCT IS MOUNTED TO FPC.

NO.	MATERIAL	FINISH	REMARKS	NO.	MATERIAL	FINISH	REMARKS
3	BRASS	CONTACT AREA : Au PLATING 0.05μm MIN. LEAD AREA : Au PLATING 0.05μm MIN. UNDERPLATING : Ni PLATING 1μm MIN.		9	POLYAMIDE		VACUUM CAP
2	BRASS	CONTACT AREA : Au PLATING 0.05μm MIN. LEAD AREA : Au PLATING 0.05μm MIN. UNDERPLATING : Ni PLATING 1μm MIN.		8	PS		REEL, BLACK
				7	POLYESTER		CLEAR
1	LCP	BLACK, UL94V-0		6	PS		CLEAR
				5	STAINLESS STEEL		-
				4	BRASS		SURFACE : Sn PLATING 1μm MIN. UNDERPLATING : Ni PLATING 0.5μm MIN.

UNITS	SCALE	COUNT	DESCRIPTION OF REVISIONS	DESIGNED	CHECKED	DATE
mm	FREE	4	DIS-H-007735	MI. SAKIMURA	TS. KUMAZAWA	13. 03. 22

APPROVED	DATE	DRAWING NO.
OM. MIYAMOTO	12. 01. 31	EDC3-339519-02
CHECED	DATE	PART NO.
OM. MIYAMOTO	12. 01. 31	DF50-20DP-1V(52)
DESIGNED	DATE	CODE NO.
TT. OHSAKO	12. 01. 31	CL665-0019-3-52
DRAWN	DATE	
TT. OHSAKO	12. 01. 31	

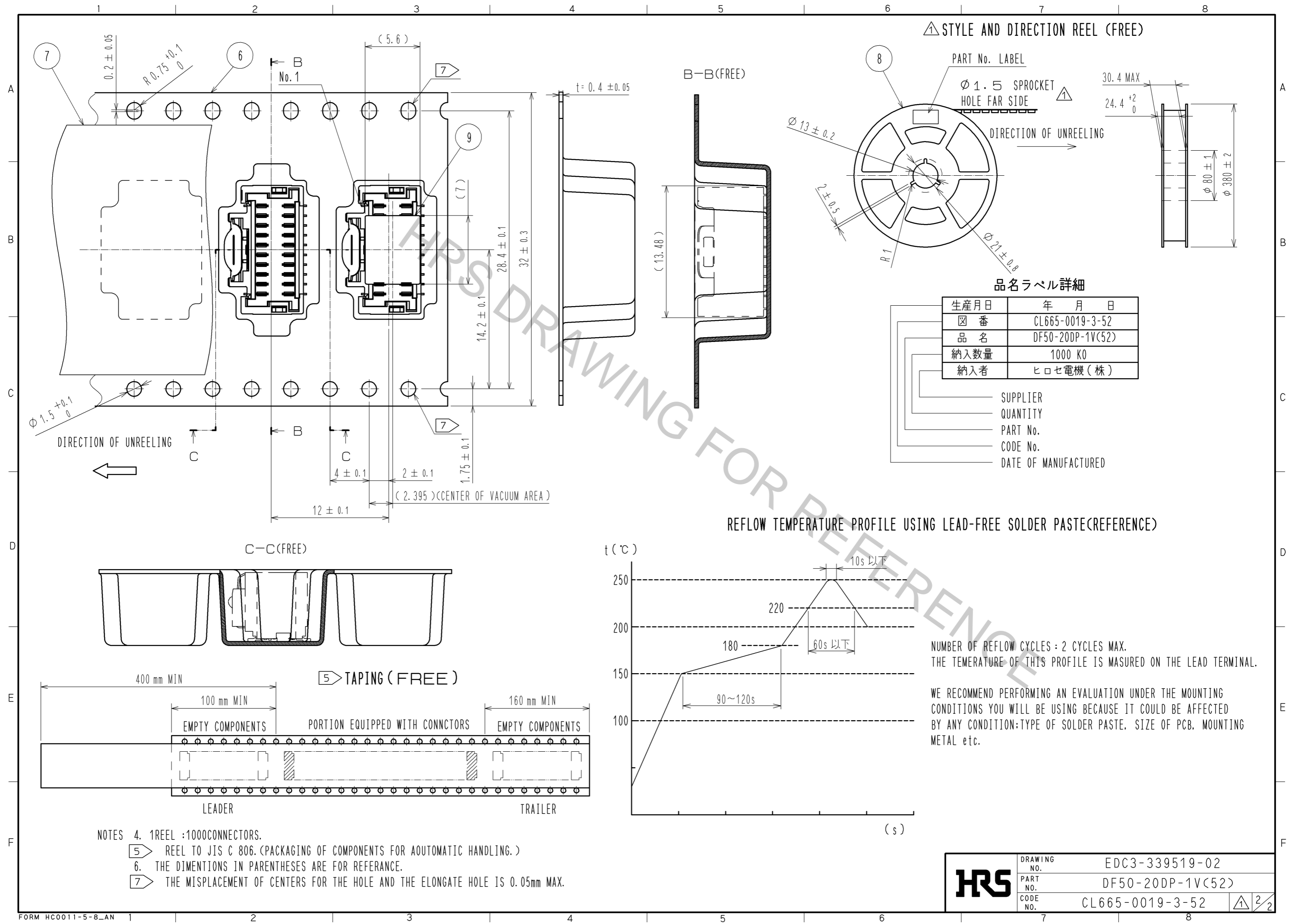

HRS	DRAWING NO.	EDC3-339519-02
	PART NO.	DF50-20DP-1V(52)
	CODE NO.	CL665-0019-3-52
		2/2