

DETAILS

Product Number	C12528_PETUNIA
Family	Petunia
Type	Lens array
Color	clear
Diameter	29,5+46,5 mm
Height	7,4 mm
Style	rectang
Optic Material	PMMA
Holder Material	
Fastening	pin
Status	production ready
ROHS Comliant	Yes
Date Updated	22/04/2015



OPTICAL PROPERTIES

LED	Viewing Angle	Light Beam	Efficiency	cd/lm	Connector
XP-E	29 deg	Medium	91 %	2.200	-
XB-D	29 deg	Medium	85 %	2.000	-
NVSxx19A	32 deg	Medium	84 %	1.700	-
Oslon SSL 150	28 deg	Medium	88 %	2.300	-

D C B A

4

4

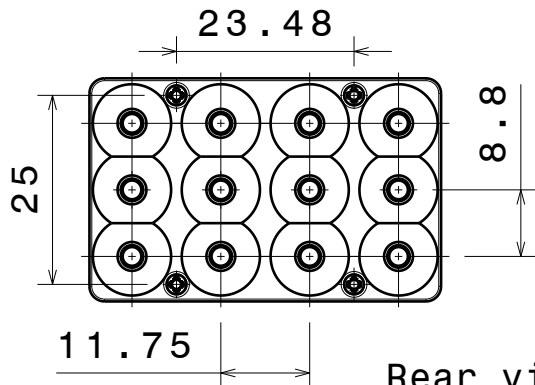
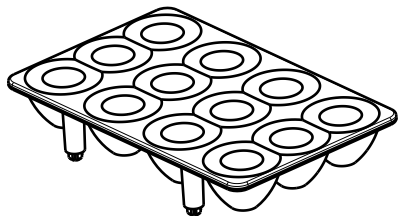

Rear view
Scale: 1:1

3

3

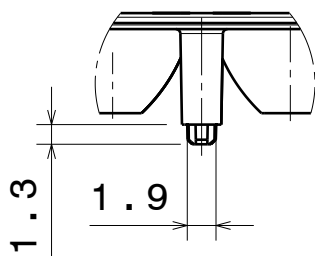

Detail A
Scale: 2:1

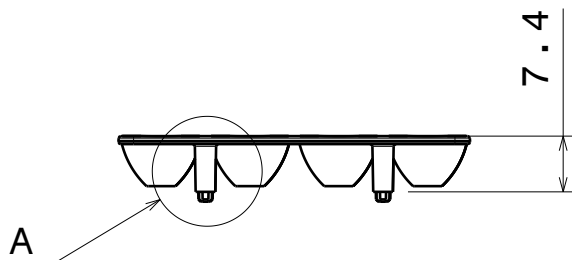

Bottom view
Scale: 1:1

2

2

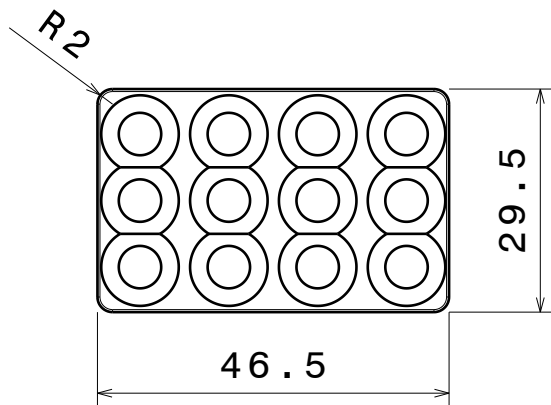

Front view
Scale: 1:1

Material: PMMA

Tolerances if not otherwise shown:
According to DIN ISO 2768-1
Linear measures:
Up to 30mm class M, otherwise class C.

According to DIN ISO 2768-2
Form and position:
class L

This drawing is our property.
It can't be reproduced
or communicated without
our written agreement.



Ledil Oy
Salorankatu 10
FIN 24240 SALO
Finland

DRAWING TITLE

Datasheet Petunia-OSL Lens

1

1

DRAWN BY pl		DATE 27.01.2012		DRAWING TITLE Datasheet Petunia-OSL Lens			
CHECKED BY xx		DATE xx.xx.2011		SIZE A4	DRAWING NUMBER C12528		REV 1
DESIGNED BY pl		DATE 13.12.2011		SCALE 1:1	WEIGHT (g)	SHEET 1/1	

D

A

Luminaire: Ledil Oy C12528_Petunia (Cree XP-E 862lm @ 250mA) Efficiency=91%
Lamps: 1 x Cree XP-E 862lm @ 250mA

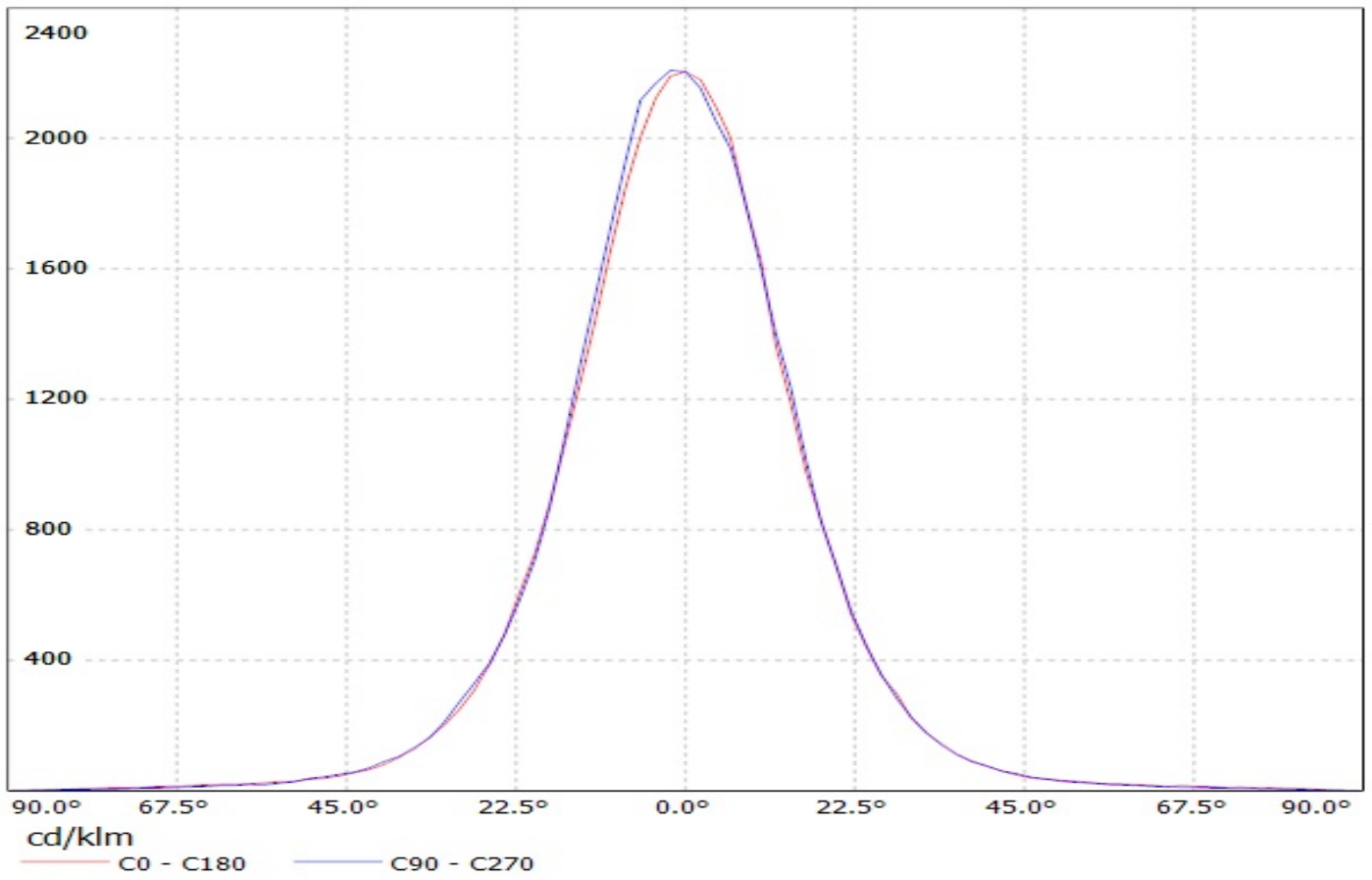

Luminaire: Ledil Oy C12528_PETUNIA (Cree XB-D 1037lm @ 250mA) Efficiency=85%
Lamps: 1 x Cree XB-D 1037lm @ 250mA

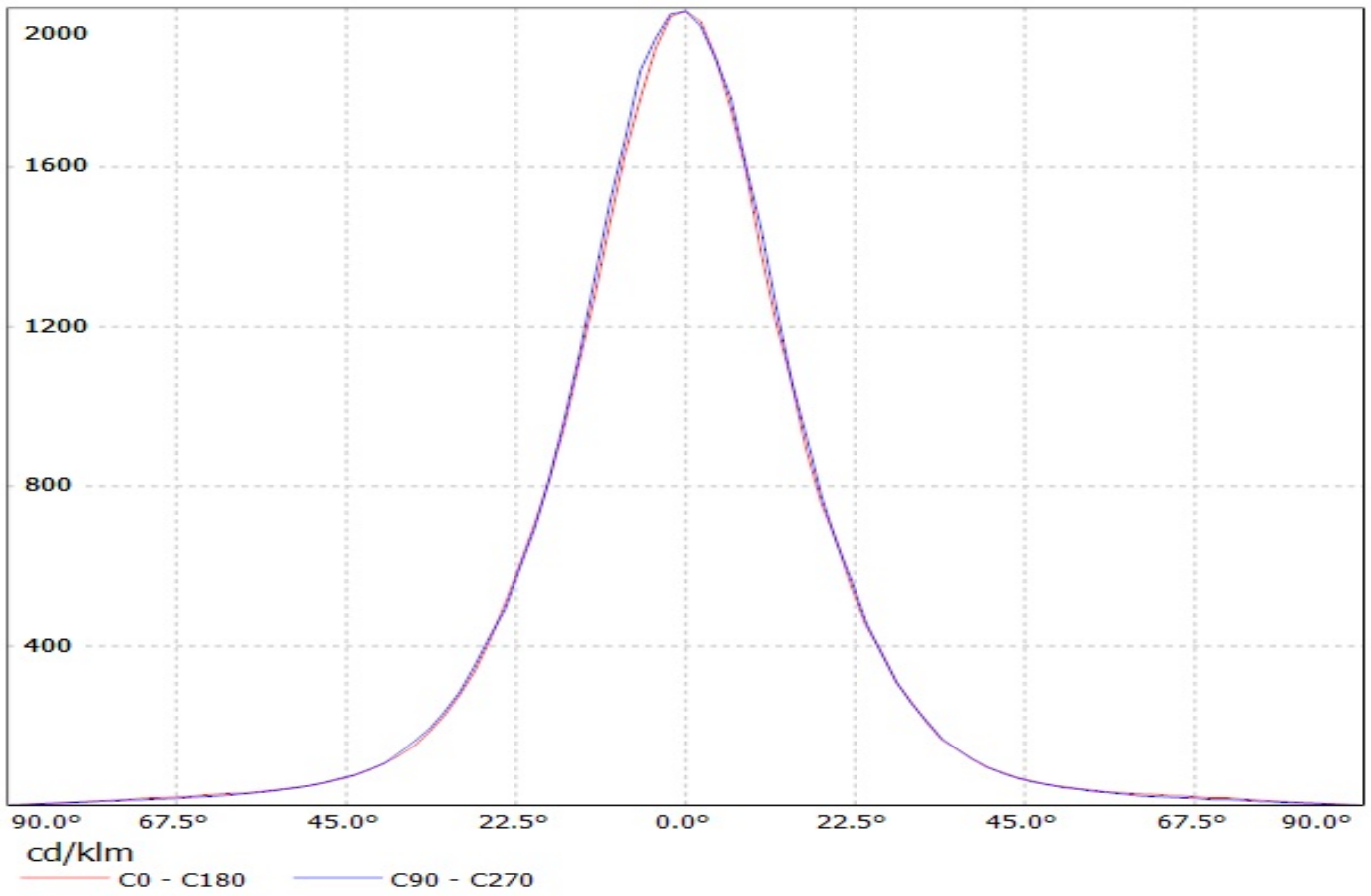

Luminaire: Ledil Oy C12528_PETUNIA (Nichia NVS19 1138lm @ 250mA) Efficiency=84%
Lamps: 1 x Nichia NVS19 1138lm @ 250mA

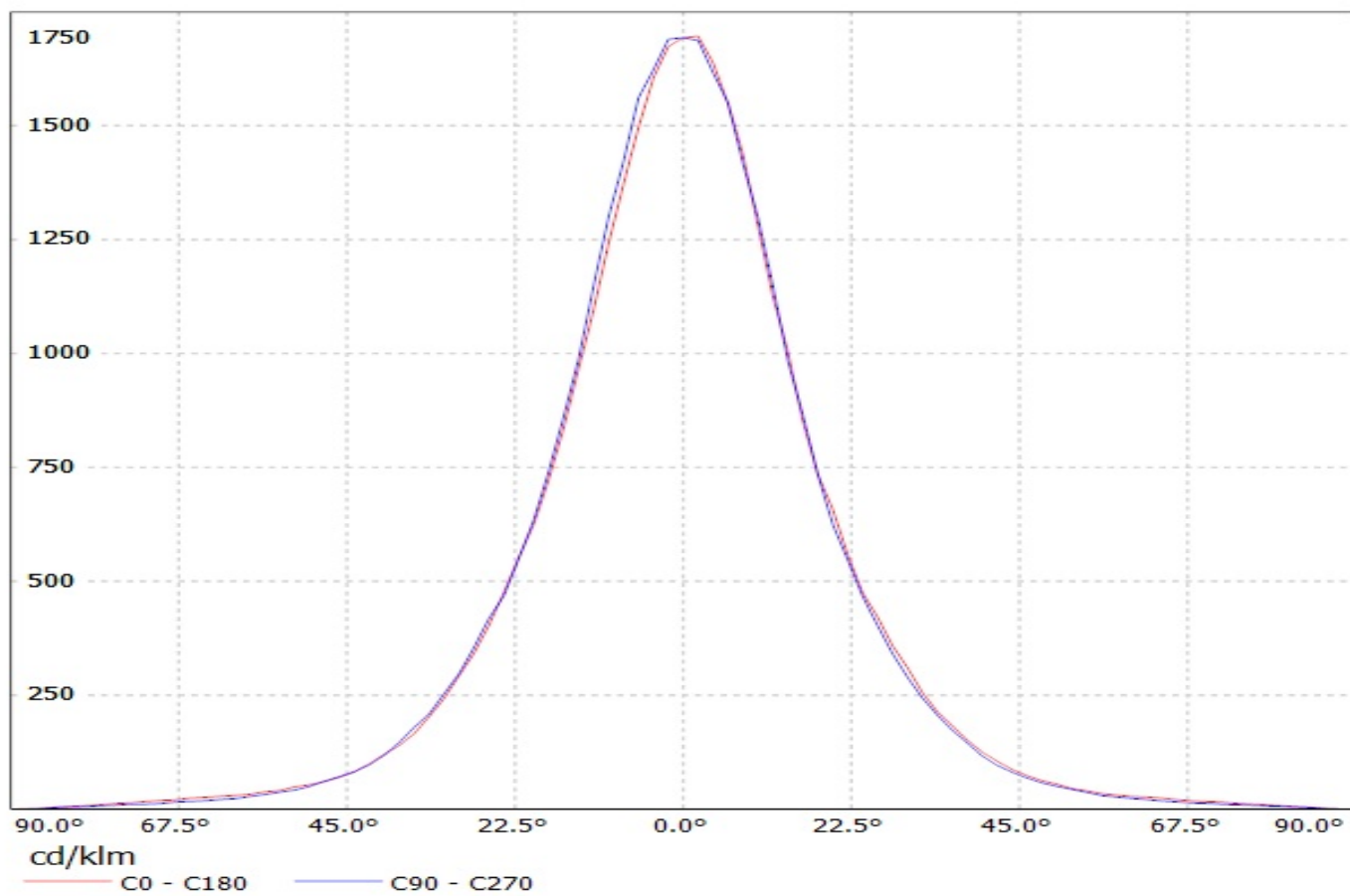

Luminaire: Ledil Oy C12528_Petunia (Osram Oslon 150dg 1173lm @ 250mA) Efficiency=87%
Lamps: 1 x Osram Oslon 150dg 1173lm @ 250mA

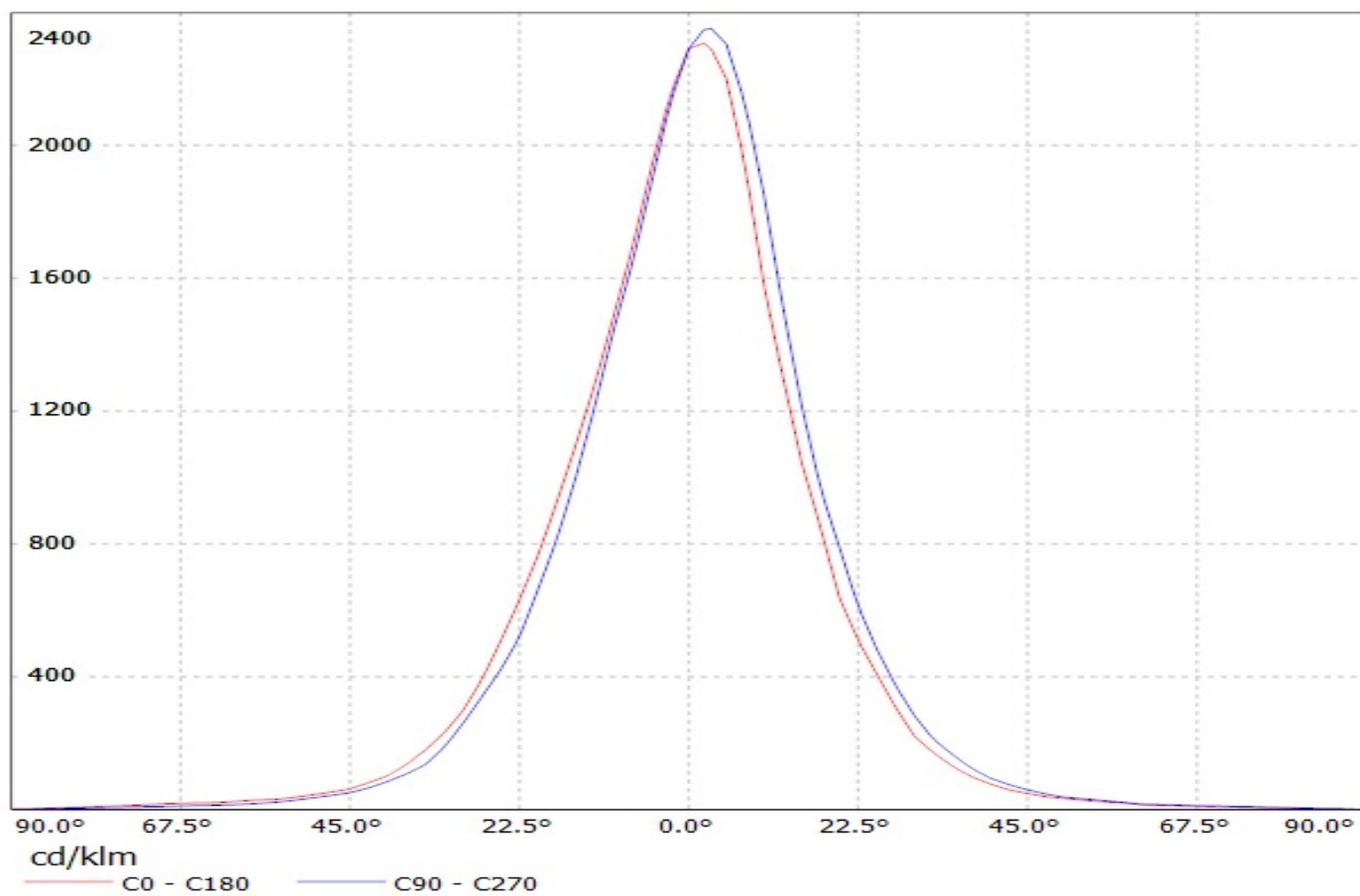

Luminaire: Ledil Oy C12528_Petunia (Cree XP-E 862lm @ 250mA) Efficiency=91%
Lamps: 1 x Cree XP-E 862lm @ 250mA

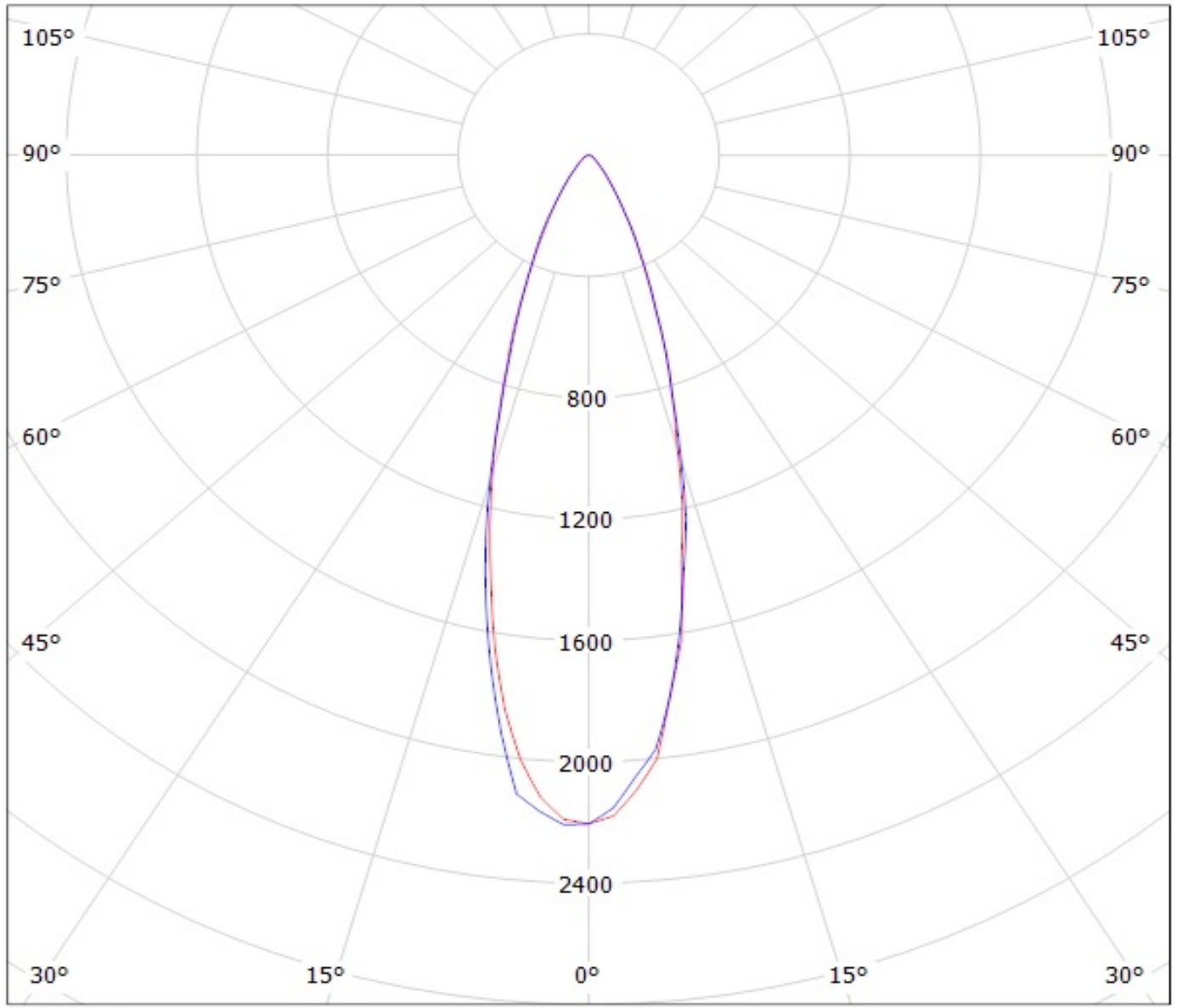

cd/klm

— C0 - C180

— C90 - C270

Luminaire: Ledil Oy C12528_PETUNIA (Cree XB-D 1037lm @ 250mA) Efficiency=85%
Lamps: 1 x Cree XB-D 1037lm @ 250mA

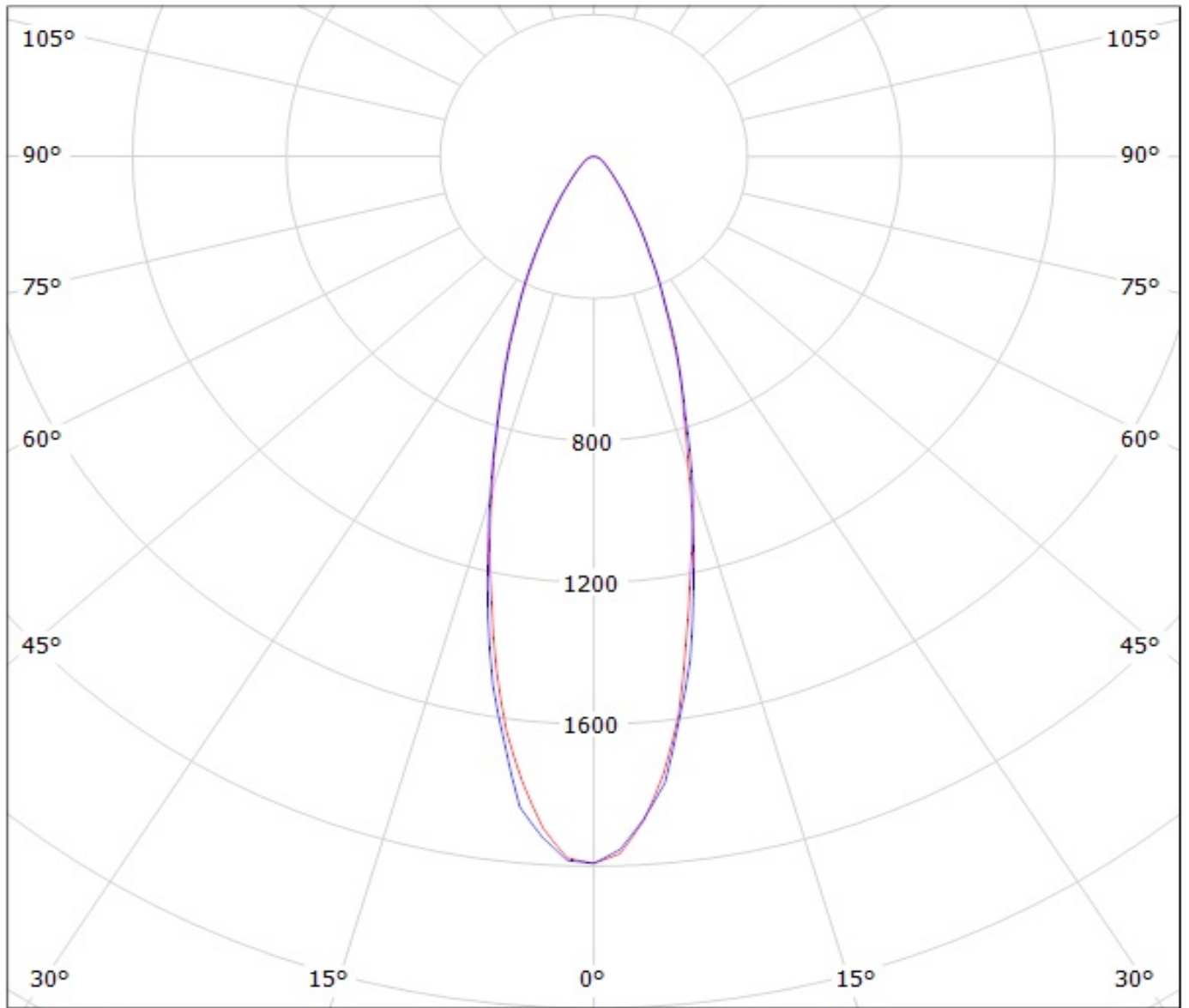

cd/klm

— C0 - C180

— C90 - C270

Luminaire: Ledil Oy C12528_PETUNIA (Nichia NVS19 1138lm @ 250mA) Efficiency=84%
Lamps: 1 x Nichia NVS19 1138lm @ 250mA

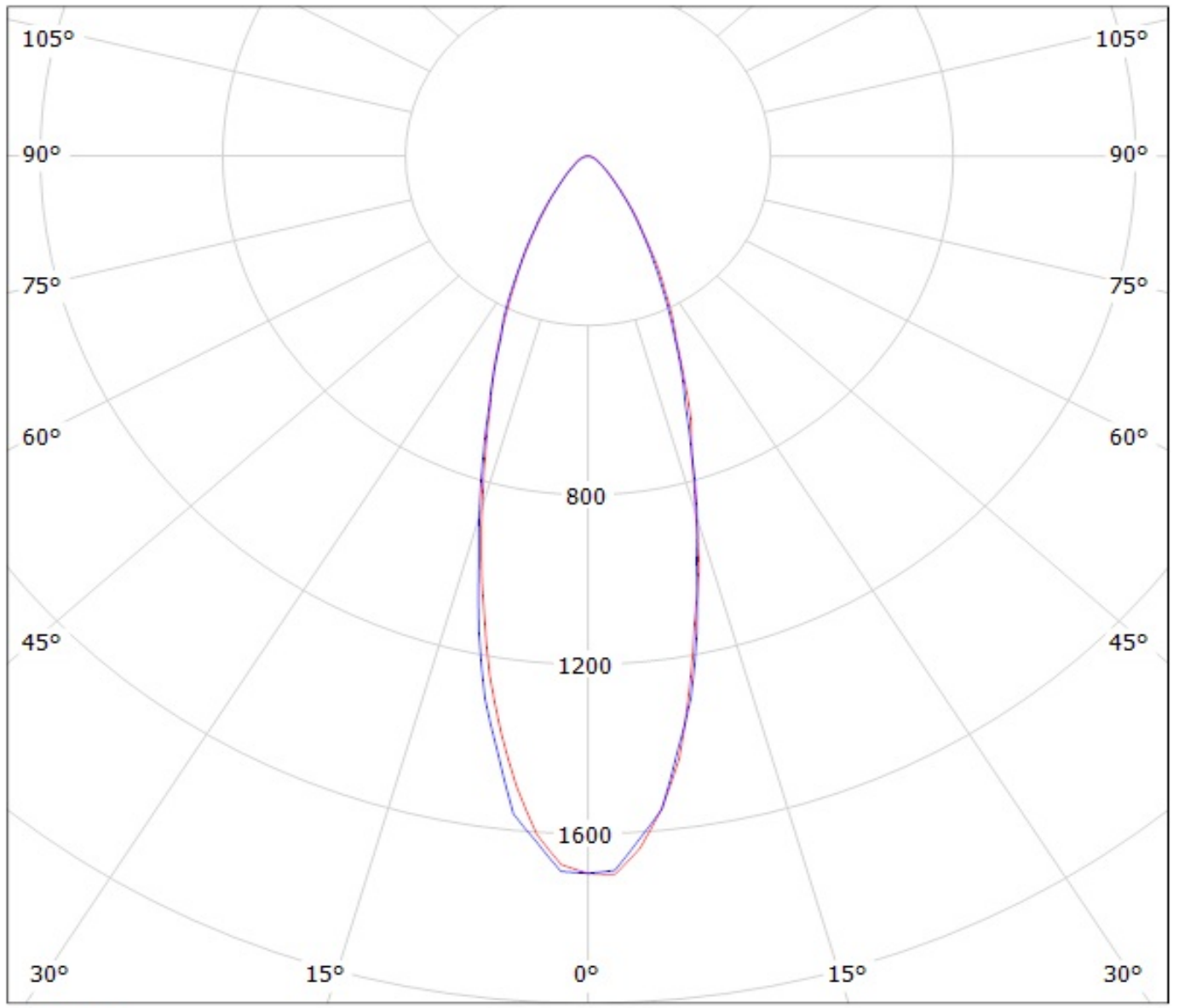

cd/klm

— C0 - C180 — C90 - C270

Luminaire: Ledil Oy C12528_Petunia (Osram Oslon 150dg 1173lm @ 250mA) Efficiency=87%
Lamps: 1 x Osram Oslon 150dg 1173lm @ 250mA

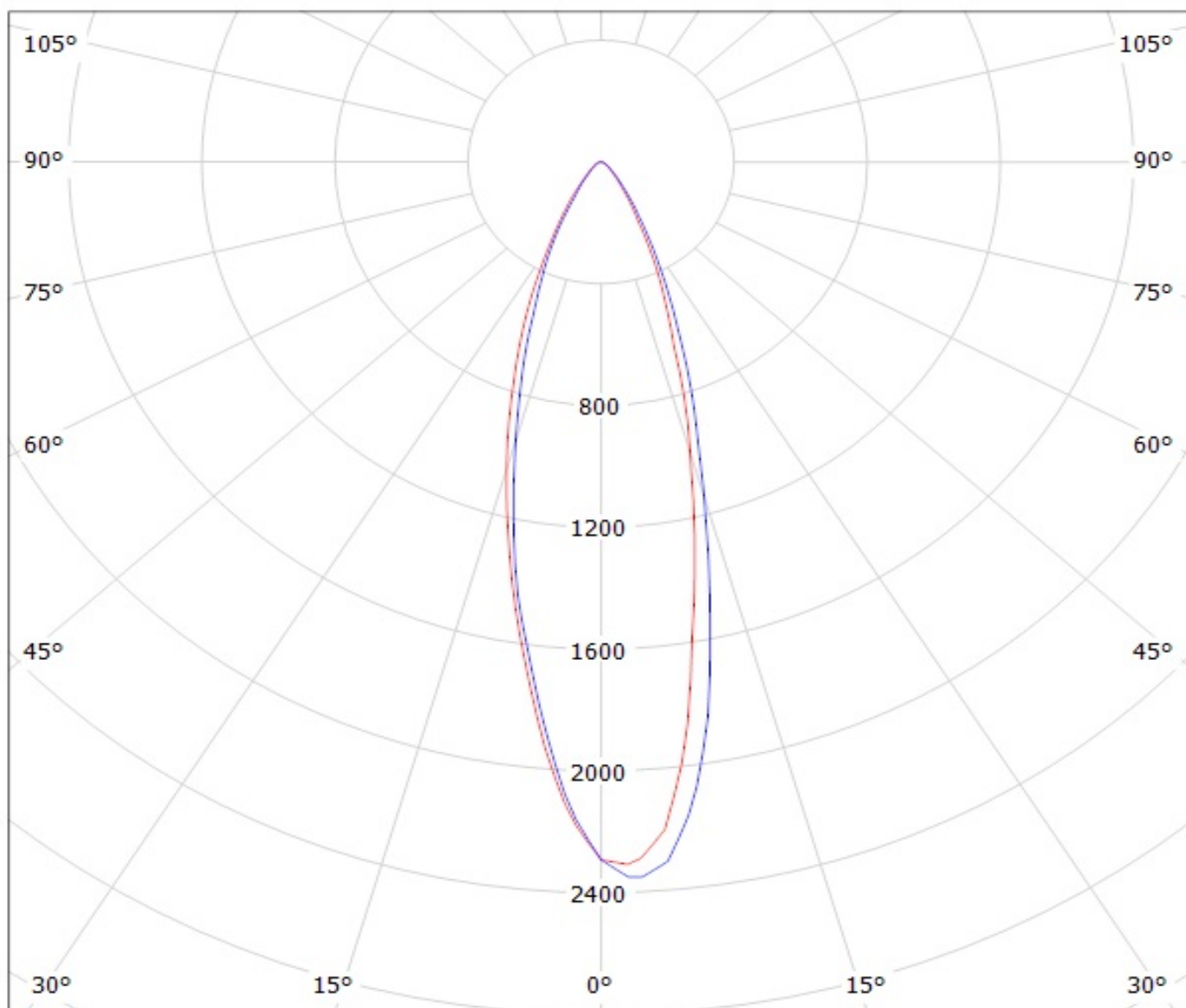

cd/klm

— C0 - C180

— C90 - C270

NOTE: The typical divergence will be changed by different color, chip size and chip position tolerance. The typical total divergence is the full angle measured where the luminous intensity is half of the peak value.