

Product Number	NOTE	PIN MAP
10123643-001LF	4mm MATING HEIGHT MATED P/N: 84512-102LF	SEE PAGE 2

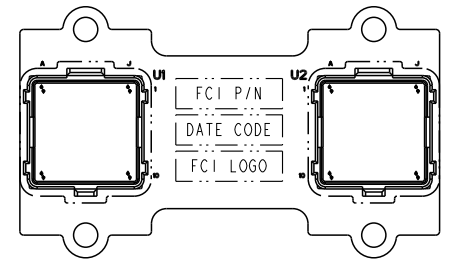

SILK SCREEN PRINTING ON TOP SIDE OF FPC:

1. FCI P/N: "10123643-001LF"
2. DATE CODE: "WWYY" (WEEK + YEAR)
3. FCI LOGO:

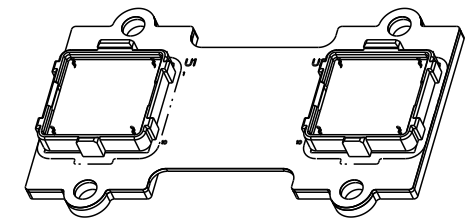
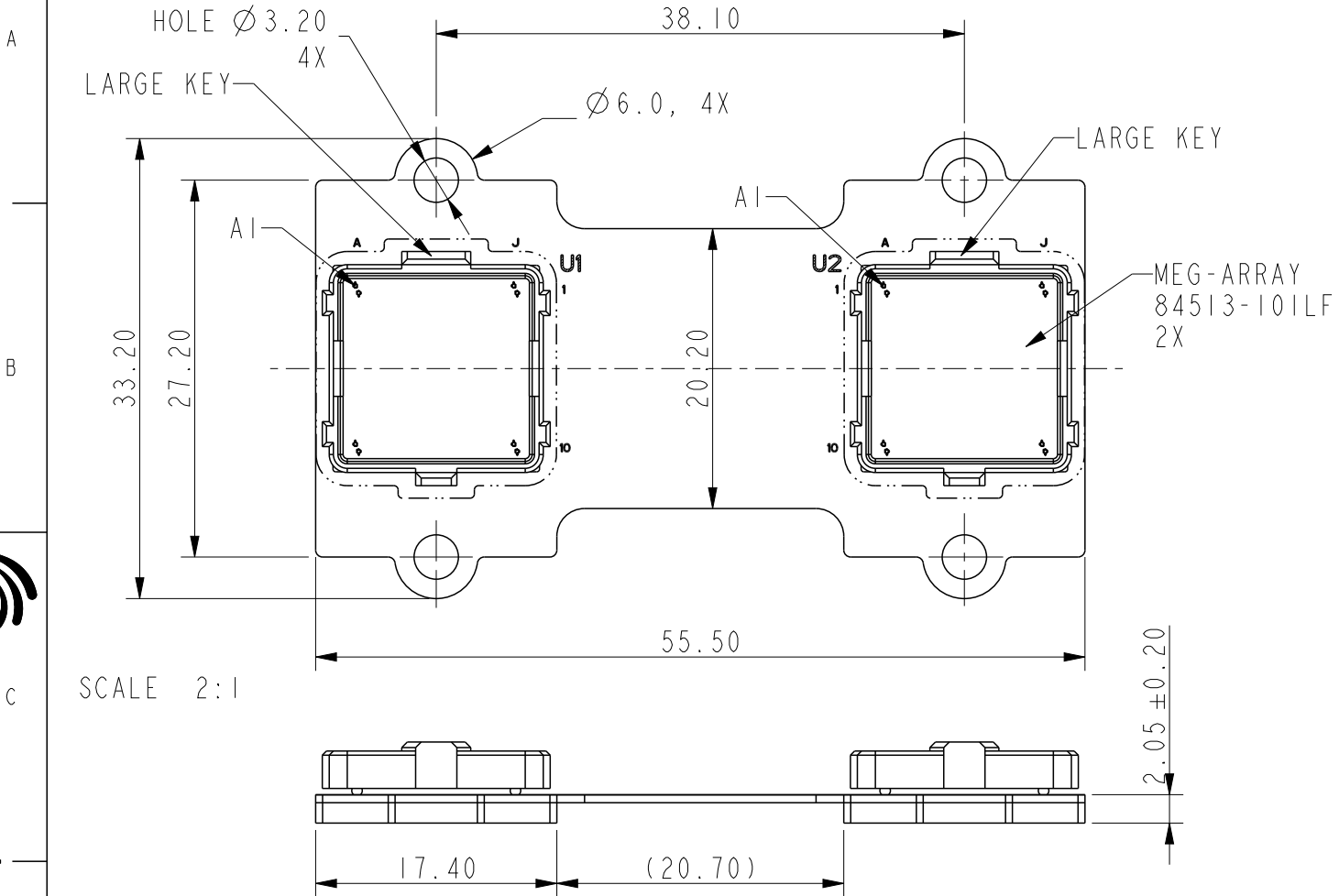
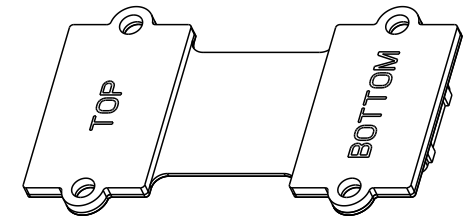

SILK MARKING ON STIFFENERS:
"TOP" FOR U1
"BOTTOM" FOR U2

SCALE 2:1



Copyright FCI.

spec ref	dr Kenny Tai 2013/03/18		projection	mm	size	A4	scale	1:1
tolerance std	eng Kenny Tai 2013/04/08				ecn no	ELX-T-14427-1		
	chr -			product family		rel level Released		
surface <input checked="" type="checkbox"/>	appr Pei-Ming Zheng 2013/04/08		title		dwg no	10123643	rev	
	TOLERANCES UNLESS OTHERWISE SPECIFIED		100 POS. MEG-ARRAY				B	
	linear	0.X	±0.3	FPC ASSEMBLY		Product - Customer Drw		
	0.XX	±0.15	cat. no.		sheet 1 of 2			
angular	0°	±°	www.fci.com					

PrdE File - REV C - 2009-06-09

PIN FUNCTION

CML	High Speed SERDES, MAX 2.5Gbps, Differential 100ohm
CML	High Speed SERDES, MAX 2.5Gbps, Differential 100ohm
LVDS	LVDS, MAX 100MHz, Differential 100ohm
LVC MOS33	LVC MOS 3.3V, Single-ended 50ohm
GND	Digital Ground

SIGNAL NAME

CML	ETX0-, ETX0+ ~ ETX6-, ETX6+
CML	ERX0-, ERX0+ ~ ERX6-, ERX6+
LVDS	10M-, 10M+, EVEN-, EVEN+, SFN-, SFN+, 3072-, 3072+
LVC MOS33	FF, PF, DEL, RST, BID0, BID1, BID2, ACT, RSVD1, RSVD0, STACK ID1, STACK ID0
GND	

NOTE:

- CONNECTOR MATERIALS:
HOUSING: HIGH TEMP. THERMALPLASTIC
CONTACT: COPPER ALLOY
- CONNECTOR PLATING:
CONTACT: 0.76um Au
- PRODUCT SPECIFICATION: GS-12-1130
- PACKAGE SPECIFICATION: GS-14-2304
- SEE CUSTOMER DRAWING OF 84513 FOR MORE CONNECTOR LAYOUT INFORMATION.
- FPC IS 6 LAYERS:
IMPEDANCE: 100 ohm FOR DIFF. PAIRS, 50 ohm FOR SINGLE END.
- IN CUSTOMER APPLICATION, BENDING TOOL WILL BE APPLIED TO FORM THE FPC SHAPE. LENGTH OF FPC ASSEMBLY IS 53.5~55mm AFTER BENDING (SEE THE PICTURE BELOW).

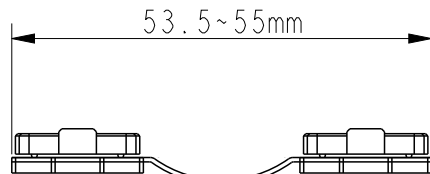

LENGTH AFTER BENDING
(NOTE 7)

8 4 5 1 3 BGA Ball View

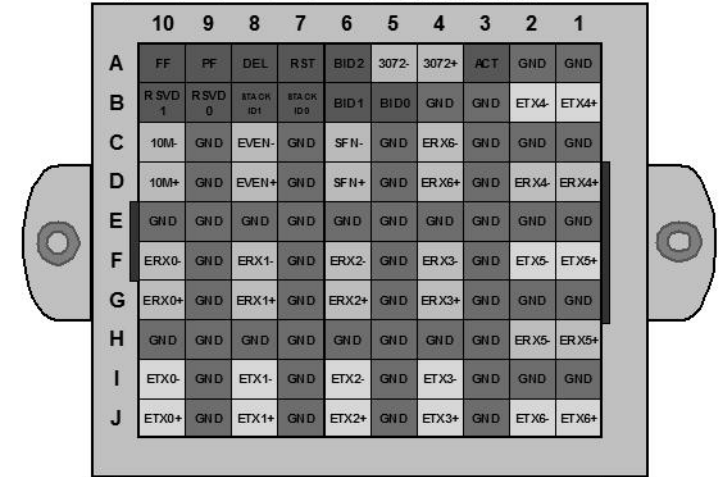

PIN MAP

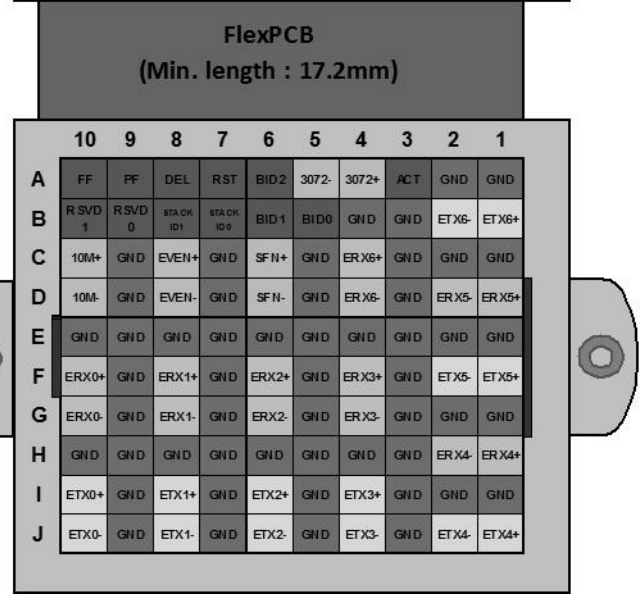

dr	Kenny Tai	2013/03/18	projection 	mm 	size	A4	scale	1:1
eng	Kenny Tai	2013/04/08			ecn no	ELX-T-14427-1		
chr	-	-			rel level	Released		
appr	Pei-Ming Zheng	2013/04/08	product family	-		rev	B	
		title		100 POS. MEG-ARRAY		dwg no		10123643
www.fci.com		cat. no.		-		Product - Customer Drw		sheet 2 of 2
		FPC ASSEMBLY						